

FED. ROAD DIST. NO.	STATE	STATE JOB NO.	FISCAL YEAR	SHEET NO.	TOTAL SHEETS
	OKLA	29289(04)		46	

DESCRIPTION	REVISIONS	DATE

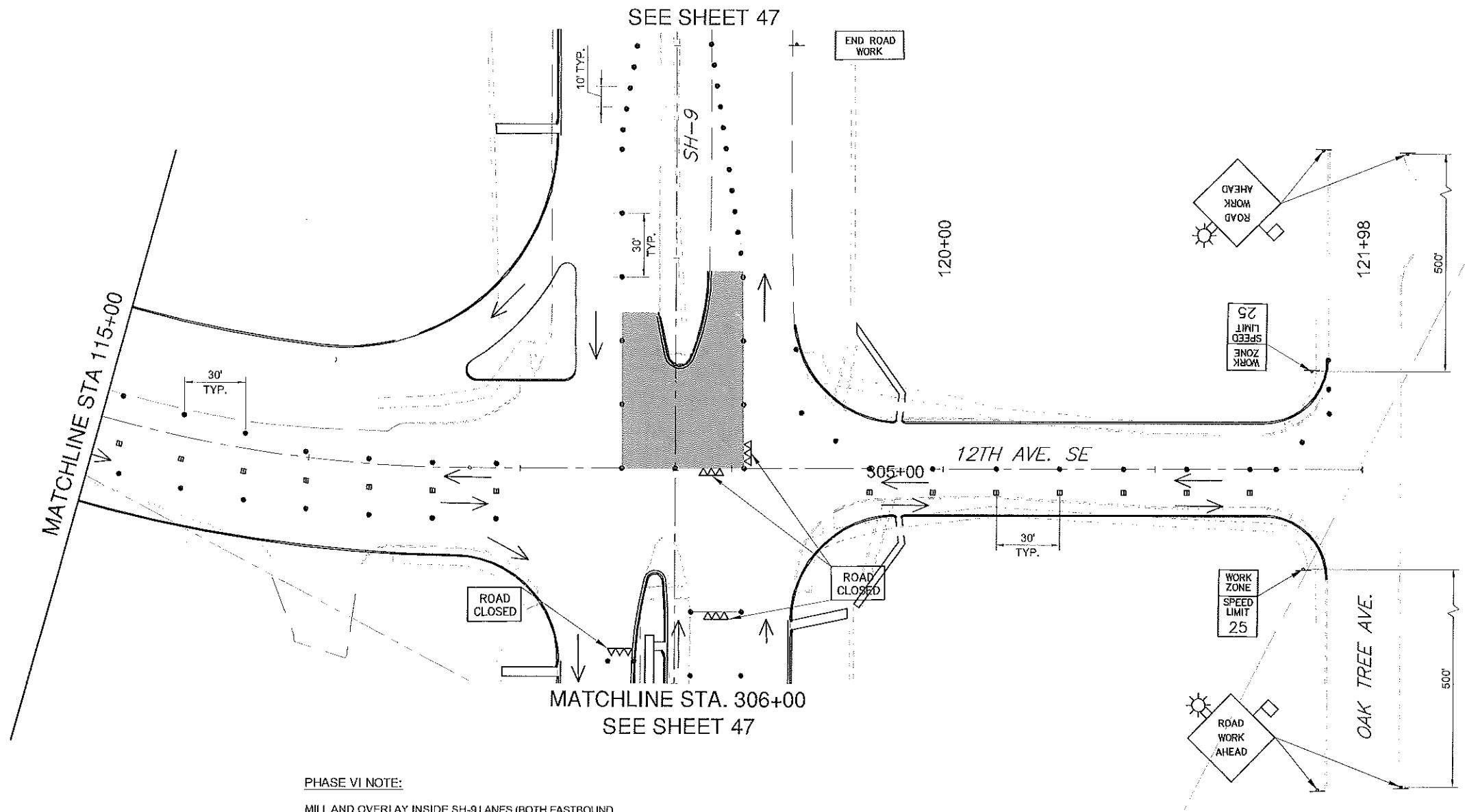
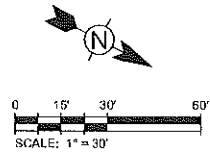

PHASE VI NOTE:

MILL AND OVERLAY INSIDE SH-9 LANES (BOTH EASTBOUND AND WESTBOUND) ON THE WEST SIDE OF THE INTERSECTION WITH 12TH AVE SE.

SH-9 SHALL REMAIN OPEN DURING CONSTRUCTION. THE CONTRACTOR SHALL BE RESPONSIBLE FOR PROPER BARRICADES, LIGHTS, AND SIGNING WITHIN THE LIMITS OF CONSTRUCTION. ALL CONSTRUCTION SIGNING WILL BE DONE ACCORDING TO STANDARDS SET FORTH IN THE MANUAL ON UNIFORM TRAFFIC CONTROL DEVICES, (CURRENT EDITION), AND AS SHOWN ON TCS STANDARD DRAWINGS.

LEGEND	
	WORK AREA
	SIGN
	DRUM
	PAVEMENT MARKER (YELLOW)
	TYPE III BARRICADE

DESIGN	SKC	OKLAHOMA DEPARTMENT OF TRANSPORTATION
DRAWN	Tt	
CHECKED	SKC	
APPROVED	MNR	
SQUAD	Tt	
		TRAFFIC CONTROL - PHASE VI
		STATE JOB NO. 29289(04)
		SHEET NO. 46

2/16/2017 4:55:26 PM - P:\BIBI\21131-08612-13001\CAD\SH-9\TRAFFIC CONTROL-PR.DWG - RODRIGUEZ, AMY